

SCHULZ

THE CHARLES M. SCHULZ MUSEUM AND RESEARCH CENTER First Floor

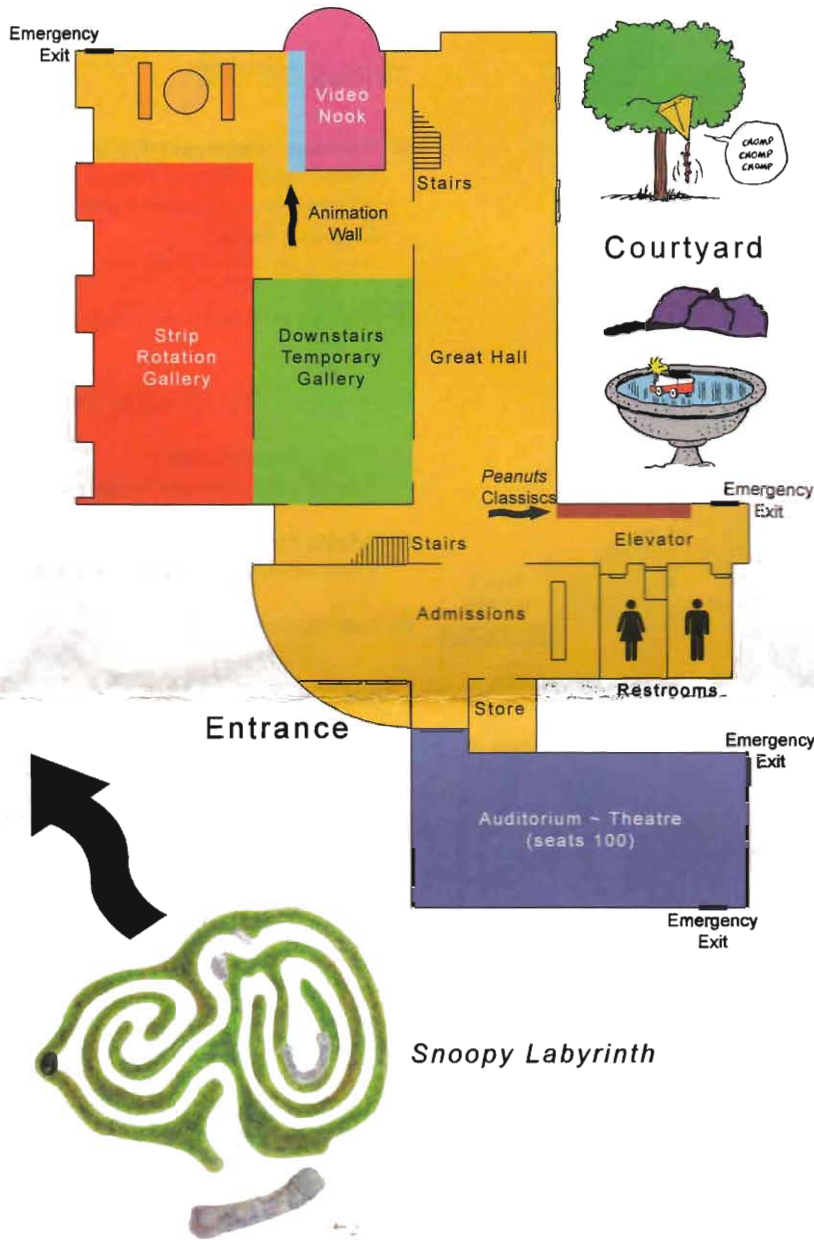

THINGS TO SEE

Video Nook

Introductory video about the creation of the Museum (continuous nine minute loop).

Strip Rotation Gallery

Original *Peanuts* comic strips and other Schulz art (changes every 4 months):

Peanuts in the Penalty Box
April 15, 2015 through August 17, 2015

Downstairs Temporary Gallery

Exhibitions exploring *Peanuts* and its role in comics history (changes every 4 - 6 months):

Animating Comics
May 2, 2015 through November 1, 2015

Peanuts Classics

Explore some of the classic themes of *Peanuts* with these original comic strips.

Animation Wall

View storyboards, animation cells, and read stories about how the *Peanuts* animated specials were created.

Great Hall

Morphing Snoopy has relief wood sculpture and ceramic tile mural by Yoshi Otani.

Auditorium ~ Theatre

Programs, documentaries, and cartoons - schedule posted outside Theatre doors.

Courtyard

Kite-eating tree, birdbath with holograms, shimmering drinking fountains, and other outdoor exhibits.

THINGS TO DO

Walk the *Snoopy Labyrinth* - the symbolic design has a single path leading to the center and back out again.
East of the Museum Entrance

Browse through scrapbooks of personal letters, photographs, and articles - add your own message or drawing.
Gallery & Upstairs Mezzanine Lounge

Visit the Museum Store for logo products sold only by the Museum.



Photography:

Photos may be taken in the Museum. Exceptions are noted with signage. Please turn your camera/phone flash off when entering the museum.



The Museum is wheelchair accessible.

CHARLES M. SCHULZ MUSEUM AND RESEARCH CENTER
2301 HARDIES LANE, SANTA ROSA, CALIFORNIA 95403 U.S.A.
(707) 579-4452 www.SchulzMuseum.org

SCHULZ

THE CHARLES M. SCHULZ MUSEUM AND RESEARCH CENTER Second Floor

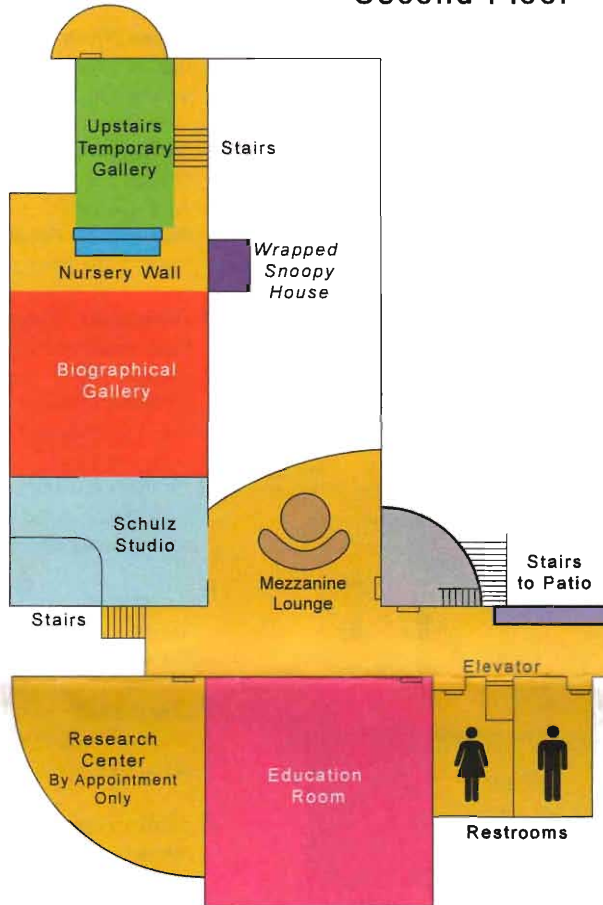

THINGS TO SEE

- **Upstairs Temporary Gallery**
Varied exhibitions of *Peanuts* in art, history, and culture (changes every 4 months):
Ghosting Schulz
January 14, 2015 through June 7, 2015
- Nursery wall painted by Schulz in his Colorado home in 1951.
- **Wrapped Snoopy House** by Christo and Jeanne Claude
- **Biographical Gallery**
Schulz's timeline and biographical exhibitions.
- **Schulz Studio**
Replication of Charles Schulz's studio.
- **New to Collections**

THINGS TO LEARN

- The exhibition *From Krazy Kat to Snoopy* illustrates how the work of early cartoonists, including Milt Caniff and Bill Mauldin, influenced Schulz.
- Charlie Brown and Snoopy were featured on the cover of *Life* magazine in 1967.
Timeline - Biographical Gallery
- Exhibition of *Peanuts* strips opened at the Musée du Louvre in Paris, France in 1990.
Timeline - Biographical Gallery
- ▶ Schulz was a prolific reader whose tastes ranged from Dr. Spock to Dr. Seuss - see his library.
Schulz Studio

THINGS TO DO

- Create your own cartoons, use a zoetrope, and participate in special changing programs.
Education Room



Now that you're here...don't miss out on any fun!

